

County Surveyor's Office
Stanislaus County Cal

Swamp and Overflowed Lands

Survey No 151 Correction of No 41

Township 4 South

Range 10 East

Section 2 all between the U. S. M. line and
the left bank of The Tuolumne River
in the East 1/2 of the West 1/2 of Sec 2

Base and Meridian of Mount Diablo

Containing 19.15 acres

Surveyed January 11th 1861

for James M. Hudelson

Field Notes

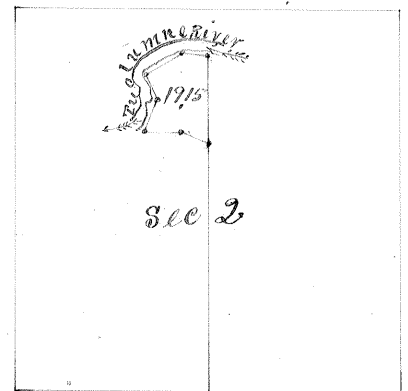

Scale 1/2 Mile to 1 Inch

Beginning on gr Section line between the East and West halves
of Sec 2 at the point of intersection with the U. S. M. line
Run on gr Sec line N 1/2° W 8.31 chs to the left bank of the
Tuolumne River, Meander down Stream Run, N 86 3/4° W 5.50 chs,
S 60 1/4° W 8.85 chs, S 15° E 3.70 chs, S 23° W 7.40 chs to the U. S. M. line Run
on the U. S. M. line N 88 1/2° E 8.00 chs, S 67° E 6.24 chs to the place of
beginning

The above was embraced in Survey No 41 Made
February 5th 1856 for James M. Hudelson
Run by the True Meridian Magnetic Variation 15° 30' East
Surveyed in accordance with the Act of the Legislature concerning
Swamp and Overflowed Lands approved April 28th 1855 and
the instruction of the Surveyor General

Silas Wilcox

County Surveyor Stanislaus County

Approved January 23rd 1861

A. A. Higley

Surveyor General

Recorded January 31st 1861

Silas Wilcox

County Surveyor