

# RECORD OF SURVEY NO. 34- 92

IN THE UNINCORPORATED TERRITORY OF THE COUNTY OF MONO, STATE OF CALIFORNIA

BEING A SURVEY OF A PORTION OF THE NORTHEAST QUARTER OF  
SECTION 21, TOWNSHIP 2 SOUTH, RANGE 26 EAST, M.D.M.

**SURVEYOR'S STATEMENT:**

THIS MAP CORRECTLY REPRESENTS A SURVEY MADE BY ME OR UNDER MY DIRECTION IN CONFORMANCE WITH THE REQUIREMENTS OF THE PROFESSIONAL LAND SURVEYOR'S ACT AT THE REQUEST OF ROBERT FOSTER IN JULY, 2009.

DAVID LAVERTY  
L.S. NO. 4587  
LIC. EXP. 9-30-10

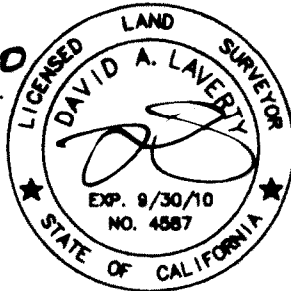
**COUNTY SURVEYOR'S STATEMENT:**

THIS MAP HAS BEEN EXAMINED IN ACCORDANCE WITH SECTION 8766 OF THE PROFESSIONAL LAND SURVEYOR'S ACT THIS 12<sup>th</sup> DAY OF August 2010.

MONO COUNTY SURVEYOR

JOHN S. PARRISH  
L.S. NO. 5050  
LIC. EXP. 6-30-12

08-12-2010  
DATE

**RECORDER'S STATEMENT:**

INSTRUMENT NO. : 2010003901  
FEE : \$ 8.00

FILED THIS 23<sup>rd</sup> DAY OF August 2010  
AT 2:40 P.M. IN BOOK 4 OF RECORD OF  
SURVEY MAPS AT PAGE 83 AT THE REQUEST  
OF TRIAD HOLMES ASSOCIATES

LYNDA ROBERTS  
MONO COUNTY RECORDER

BY: Sherrie A. Hale  
DEPUTY COUNTY RECORDER

**PURPOSE OF SURVEY**

THE REASON FOR THIS RECORD OF SURVEY IS AS SET FORTH IN THE PROFESSIONAL LAND SURVEYOR'S ACT, ARTICLE 5, 8762(b)(5): THE POINTS OR LINES SET DURING THE PERFORMANCE OF A FIELD SURVEY OF ANY PARCEL DESCRIBED IN ANY DEED OR OTHER INSTRUMENT OF TITLE RECORDED IN THE COUNTY RECORDER'S OFFICE ARE NOT SHOWN ON ANY SUBDIVISION MAP, OFFICIAL MAP, OR RECORD OF SURVEY.

**LEGAL DESCRIPTION**

LOTS 1 THROUGH 9 AND LOTS 22 THROUGH 24 OF BLOCK 22 OF SILVER LAKES PINES TRACT NO. 4 AS PER MAP RECORDED IN BOOK 1 PAGE 10 OF MAPS IN THE OFFICE OF THE COUNTY RECORDER OF SAID COUNTY. EXCEPTING THEREFROM THAT PORTION OF LOT 9 LYING EASTERLY OF THE CENTERLINE OF THE STREAM AS EXCEPTED IN DEED RECORDED MAY 6, 1929, IN BOOK 3 PAGE 146 OF OFFICIAL RECORDS WITH THAT PORTION OF RIVERSIDE DRIVE VACATED BY RESOLUTION NO. R00-70, APPROVED AND ADOPTED THE 5TH DAY OF SEPTEMBER, 2000, BY THE BOARD OF SUPERVISORS, COUNTY OF MONO.

SCALE: 1" = 30'

**LEGEND:**

- FOUND MONUMENT AS NOTED
- SET 5/8" REBAR W/CAP "LS 4587"

(R) RECORD  
(M) MEASURED  
(C) CALCULATED  
(CFR) CALCULATED FROM RECORD  
(P) PROPORTIONED FROM RECORD  
FND. FOUND  
I.P. IRON PIPE  
SFN SEARCHED FOR, NOT FOUND

**RECORD INFORMATION:**

- (R1) = RECORD INFORMATION PER MAP BOOK 1, PAGE 10.  
(R2) = RECORD INFORMATION PER GRANT DEED BOOK 3, PAGE 146.  
(R3) = RECORD INFORMATION PER CORNER RECORD 2526-21-4  
(R4) = RECORD INFORMATION PER PARCEL MAP BOOK 4, PAGE 23.

**BASIS OF BEARINGS**

THE BASIS OF BEARINGS IS BETWEEN FOUND MONUMENTS ON THE WESTERLY LINE OF LOT 1 BLOCK 25 AS SHOWN ON CORNER RECORD 25-26-21-4 AND LISTED HEREON AS N 01°17'44" E.

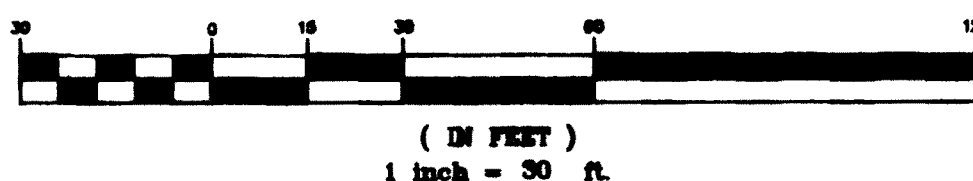
**GRAPHIC SCALE**

NOTE:  
THE FOLLOWING LINE TABLE REFLECTS THE CENTERLINE CHORD OF THE STREAM OBSERVED ON THE DATE OF THIS SURVEY. THEY SHOULD NOT BE INTERPRETED AS BOUNDARY LINES.

LINE	BEARING	LENGTH
L1	S41°49'15"W	28.26
L2	S10°18'14"W	9.99
L3	S09°51'09"E	14.39
L4	S38°40'32"E	17.49

