

15-124

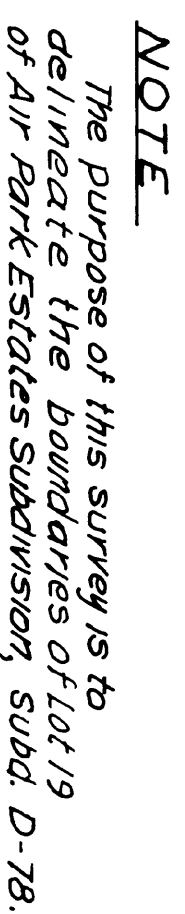

A PORTION OF SECTION 33, T10N, R9E, MD.M.  
LOT 19 AIR PARK ESTATES, SUBD. D-78  
COUNTY OF EL DORADO STATE OF CALIFORNIA  
APRIL, 1988 SCALE: 1"=20'  
JOHN T. RICHARDS ~ LAND SURVEYOR

*This map correctly represents a survey made by me or under my direction in conformance with the requirements of the Land Surveyor's Act at the request of Paul J. Brumfield in April, 1988.*

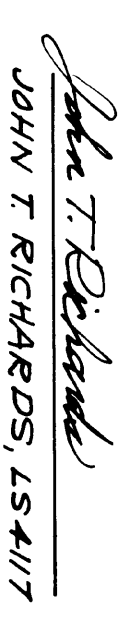

This map has been examined in accordance with Section 8766 of the Land Surveyor's Act this 20<sup>th</sup> day of June, 1988.

Filed this 20th day of June, 1989, at 1:27 P. M.  
in Book 15 of Record of surveys at page 234 at  
the request of Paul J. Brumfield.

Document No. 33118

Dorothy Carr  
DOROTHY CARR  
COUNTY RECORDER  
COUNTY OF EL DORADO  
By Theresa S. Steele  
DEPUTY

A PORTION OF SECTION 33, T10N, R9E, MD.M.  
LOT 19 AIR PARK ESTATES, SUBD. D-78  
COUNTY OF EL DORADO STATE OF CALIFORNIA  
APRIL, 1988 SCALE: 1"=20'  
JOHN T. RICHARDS ~ LAND SURVEYOR

*This map correctly represents a survey made by me or under my direction in conformance with the requirements of the Land Surveyor's Act at the request of Paul J. Brumfield in April, 1988.*

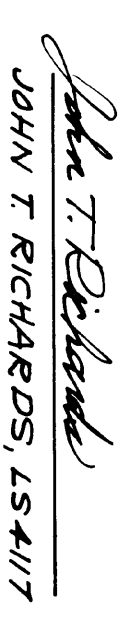

This map has been examined in accordance with Section 8766 of the Land Surveyor's Act this 20<sup>th</sup> day of June, 1988.

Filed this 20th day of June, 1989, at 1:27 P. M.  
in Book 15 of Record of surveys at page 234 at  
the request of Paul J. Brumfield.

Document No. 33118

Dorothy Carr  
DOROTHY CARR  
COUNTY RECORDER  
COUNTY OF EL DORADO  
By Theresa S. Steele  
DEPUTY