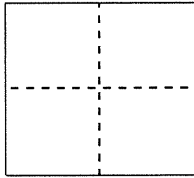

**CORNER RECORD**Document Number **CR 9743**City of Oakland (APN 32-2099-16)County of Alameda, CaliforniaBrief Legal Description Monument at the intersection of 38<sup>th</sup> Avenue and Santa Rita Street, near 2301 38<sup>th</sup> Avenue**CORNER TYPE**

Government Corner ☐ Control ☒  
 Meander ☐ Property ☐  
 Rancho ☐ Other ☐

Date of Survey January 5, 2017**COORDINATES (Optional)**

N. \_\_\_\_\_  
 E. \_\_\_\_\_  
 Zone \_\_\_\_\_ NAD27 ☐ NAD83 ☐  
 NAD83 Epoch \_\_\_\_\_  
 Elev. \_\_\_\_\_  
 Vert. Datum: NGVD29 ☐ NAVD88 ☐  
 Meas. Units: Metric ☐ Imperial ☐

**Pre-construction (waterline) Corner Record**

Corner - Left as found ☒ Found and tagged ☐ Established ☐ Reestablished ☐ Rebuilt ☐

Identification and type of corner found: Evidence used to identify or procedure used to establish or reestablish the corner:  
 Found monument that could be damaged or destroyed by planned water line construction project..

Monument was referenced as shown on page 2. The purpose of this Corner Record is to preserve possible evidence only; no attempt was made to determine the relationship to property, centerline, or right of way lines.

A description of the physical condition of the monument as found and as set or reset:

Monument was found in good condition and was referenced with four set reference points representing two intersecting lines as shown on Page 2.

Reference EBMUD Field Book 4590, Page 73 (Poulsen/Liu)

**SURVEYOR'S STATEMENT**

This Corner Record was prepared by me or under my direction in conformance with the Professional Land Surveyor's Act on FEBRUARY 16, 2017

Signed

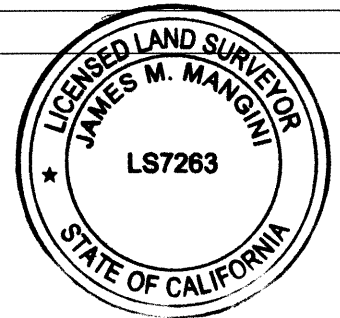
James M. ManginiP.L.S. or R.C.E. No. 7263**COUNTY SURVEYOR'S STATEMENT**

This Corner Record was received 21 FEBRUARY, 2017  
 and examined and filed 17 MAY, 2017

Signed

Michael RubnerP.L.S. or R.C.E. No. 6843

Title

COUNTY SURVEYOR

County Surveyor's Comment: \_\_\_\_\_

OAKLAND

MAP OF

ALAMEDA COUNTY

BOULEVARD PARK

21 M 50

BLOCK 15

2301 38TH AVENUE

APN 32-2099-16

1

SANTA RITA STREET  
80'

38TH AVENUE  
(BOULEVARD PARK AVE)  
80'

16  
BLK 14

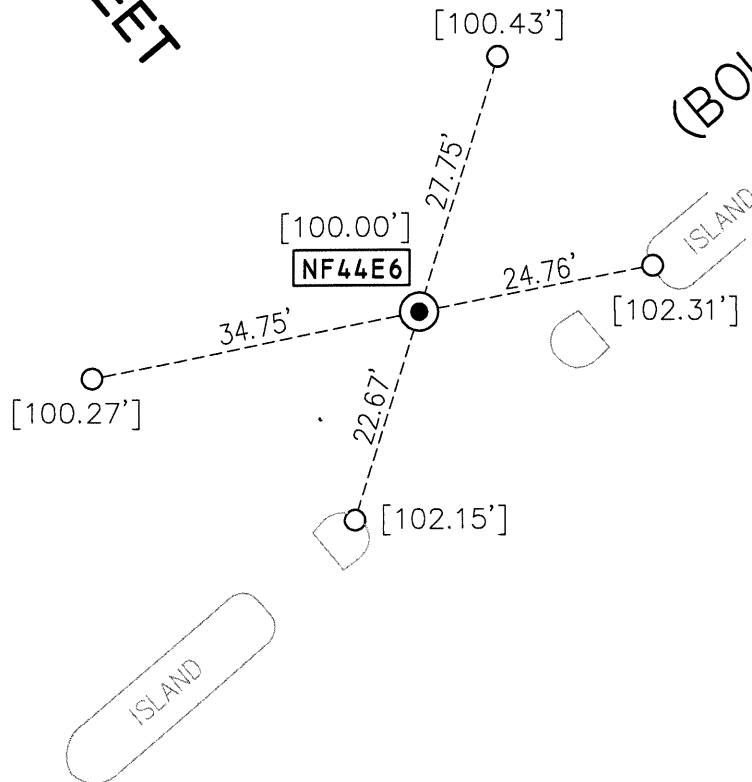

BLK 20  
17

## LEGEND



FOUND 3/16" BRASS PIN IN CONCRETE POST, 1.3' DOWN, IN STANDARD CITY MONUMENT WELL



SET CONCRETE ANCHOR NAIL AND 1-1/2" ALUMINUM WASHER, STAMPED "EBMUD MON RP" IN TOP OF CONCRETE CURB

NF44E6

ALAMEDA COUNTY MONUMENT DESIGNATION

[ ]

ASSUMED ELEVATION (MEASURED USING A LEICA DNA10 DIGITAL LEVEL)



SCALE  
1"=20'



ADDRESS: 2301 38TH AVENUE  
APN: 32-2099-16

CR# 9743

CR