

CORNER RECORD

Agency Index

Document Number

134 14

CR 14310

City of FREMONTCounty of ALAMEDA, CaliforniaBrief Legal Description PIN MONUMENT LOCATED WITHIN OLIVE AVE AT TROYER AVE

CORNER TYPE

COORDINATES (Optional)

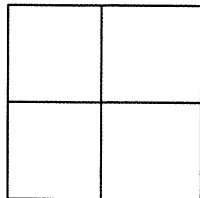

Government Corner ☐ Control ☒
Meander ☐ Property ☐
Rancho ☐ Other ☐

Date of Survey 03/10/2020

N. _____ E. _____

Elevation _____

Units Metric ☐ U.S. Survey Foot ☐

Horizontal Datum _____

Zone _____ Epoch Date _____

Vertical Datum _____

☐ Complies with Public Resources Code §§8801-8819☐ Complies with Public Resources Code §§8890-8902PLS Act Ref: ☐ 8765 (d) ☒ 8771 ☐ 8773 ☐ Other:

Corner/
Monument: ☒ Left as found ☐ Established ☐ Rebuilt ☐ Pre-Construction
☐ Found and tagged ☐ Reestablished ☐ Referenced ☒ Post-Construction

Narrative of corner identified and monument as found, set, reset, replaced, or removed:

☐ See sheet #2 for description (s) : SEE BK 124 PG 77
FOUND 1/8" PIN IN CONCRETE IN MONUMENT WELL

FOUND AND SET POINTS AS SHOWN ON PAGE 2.

THIS POINT WAS FOUND IN GOOD CONDITION AFTER A CONSTRUCTION PROJECT IN THE VICINITY.
THE TIES SHOWN HEREON ARE FOR THE PURPOSE OF PERPETUATING FOUND MONUMENTATION.
NO CLAIM IS MADE AS TO THE RELATIONSHIP OF THE POINTS OR LINES SHOWN HEREON TO TRUE
BOUNDARY LOCATION.

SURVEYOR'S STATEMENT

This Corner Record was prepared by me or under my direction in conformance with

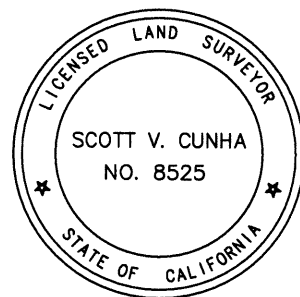
the Professional Land Surveyors' Act on MARCH 24, 2020.Signed SCOTT V. CUNHA P.L.S. or R.C.E. No. LS 8525

COUNTY SURVEYOR'S STATEMENT

This Corner Record was received APR 09 2020and examined and filed APR 13 2020.Signed D. Ian Wilson P.L.S. or ~~P.C.E.~~ No. LS 7010Title COUNTY SURVEYOR

County Surveyor's Comment



SCALE: 1"=30'

LEGEND

● FOUND PIN IN CONCRETE IN MONUMENT WELL

✕ FOUND CUT CROSS IN CURB

AA### ALAMEDA COUNTY MONUMENT ID

19592 REFERENCE STREET ADDRESS



219101-Olive-POST-CR-04